

LITTLE KESWICK SCHOOL CONCEPT PLAN

DATE MAY 20, 2005	REVISIONS JUNE 20, 2006 JUNE 22, 2006	SCALE 1"=70'	LITTLE KESWICK SCHOOL ALBEMARLE COUNTY, VIRGINIA	CONCEPT PLAN	BRIAN P. SMITH, PE CIVIL ENGINEERING, INC. SITE DESIGN & LAND PLANNING 105 WEST 164th STREET CHAS. OTTENWILE, VA 22802 TEL: (434) 246-3644 FAX: (434) 246-2041 bpi@bpiengineer.com	JOB NUMBER 05-003-00	DWG. NAME property layout.prc	SHEET 1 of 1
----------------------	---	-----------------	---	--------------	---	-------------------------	----------------------------------	-----------------

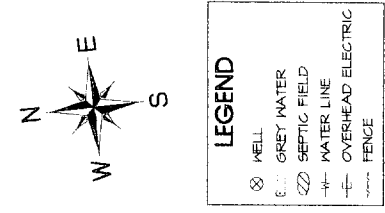

PROJECT DATA

- PROJECT NAME: LITTLE KESWICK SCHOOL.
- OWNER: L&S ENTERPRISES, LLC
601 W. VA
KESWICK, VA 22947
- DEVELOPER: SAWE
- TAX MAP PARCELS: 09000-00-00-10, 110A, 110A(1), 110A(2), 111, 112, 117A, 118, 119
- LOCAL JURISDICTION: ALBEMARLE COUNTY, VIRGINIA
- ZONING: RA RURAL RESERVE
- PRESENT USE: LITTLE KESWICK SCHOOL.
- PROPOSED USE: SAME
- ADDITIONAL NOTES:
I. THE SITE DOES NOT LIE WITHIN THE RIVANA RESERVOIR WATERSHED.
II. THIS PROJECT IS NOT WITHIN A LEPHANT 100 YEAR FLOOD ZONE.
III. THIS PROJECT IS SERVED WITH PRIVATE WATER AND SEPTIC.
IV. REFER TO 99-20026-13
V. MAXIMUM ENROLLMENT: 31
VI. MAXIMUM NUMBER OF STAFF: 15
VII. DAY STAFF: 23 - DEPOT
VIII. NIGHT STAFF: 6 - DEPOT
IX. OFFICE HOUSE
X - TOTAL NIGHT TIME
XI. PARKING:
TOTAL EXISTING 12 SPACES
NO INCREASE IN POPULATION, THEREFORE NO ADDITIONAL SPACES PROPOSED.

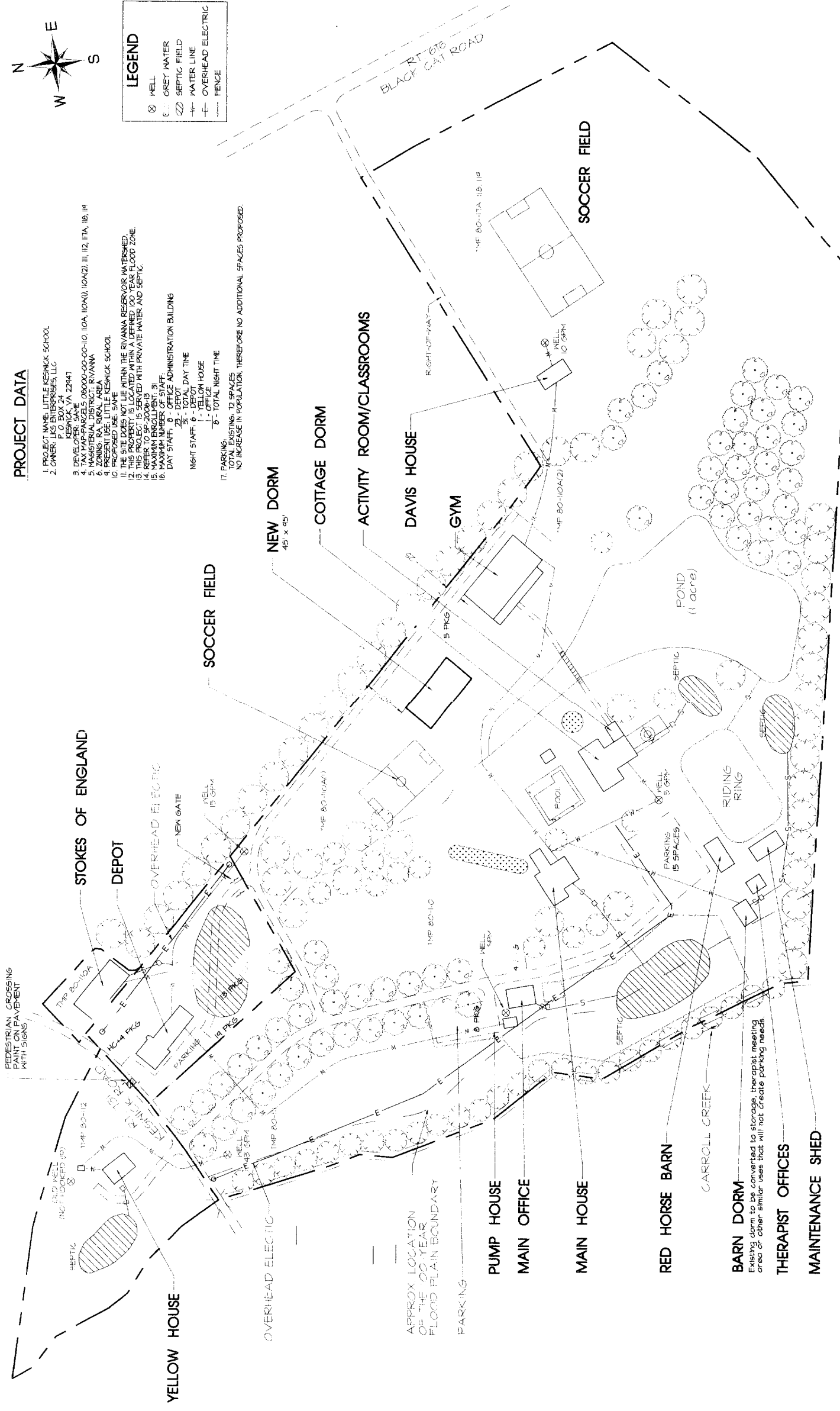

05-003-00
1 of 1