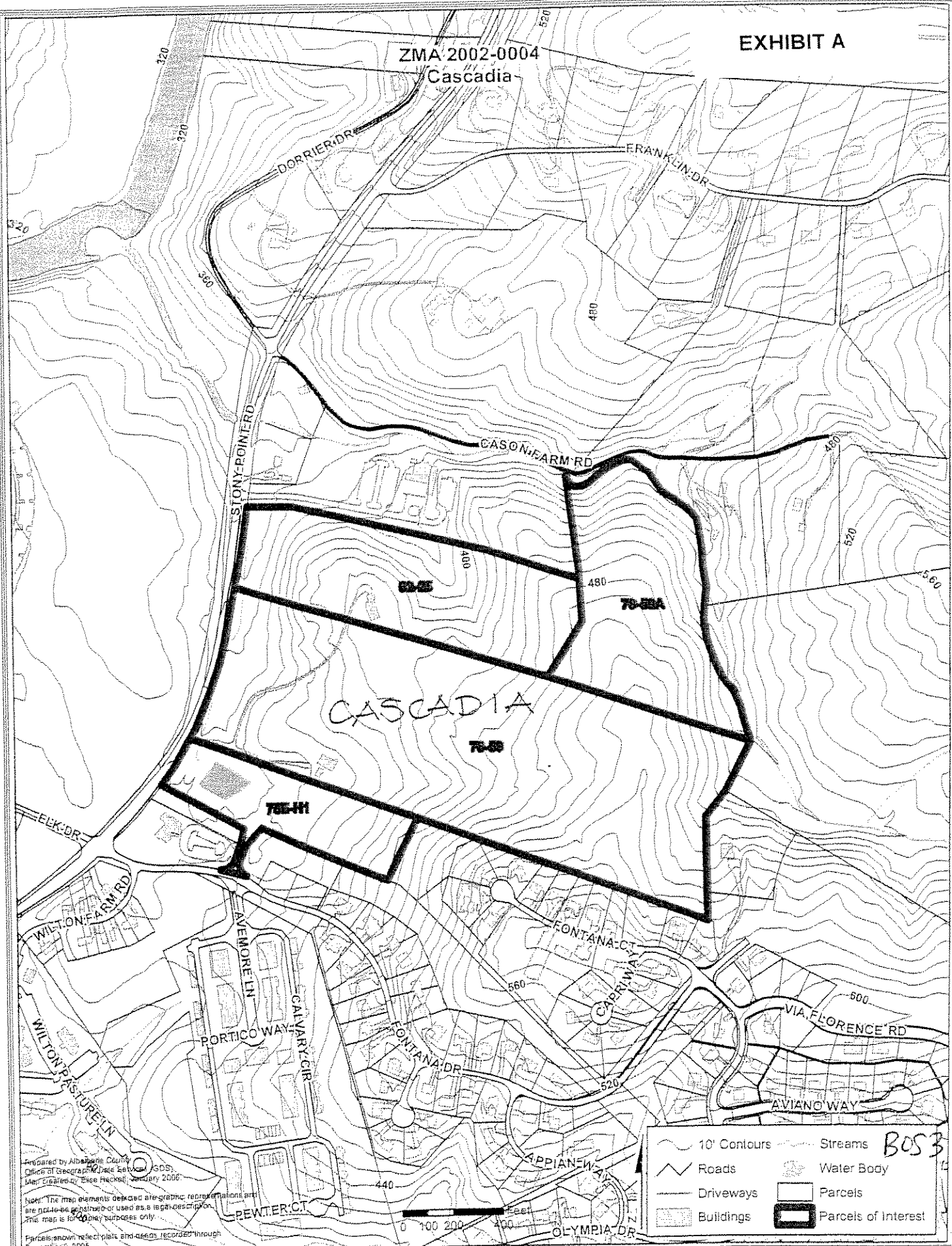

EXHIBIT A

ZMA 2002-0004

Cascadia



Prepared by Albemarle County
 Office of Geographic Data Services
 Map Created by: Essex Hockett, January 2006

Note: The map elements depicted are graphic representations and are not to be construed or used as a legal description. This map is for public purposes only.

Parcels shown reflect plats and deeds recorded through December, 2005.

	10' Contours		Streams
	Roads		Water Body
	Driveways		Parcels
	Buildings		Parcels of Interest

BOSB