

**City of Charlottesville
School Board &
County of Albemarle
(C.A.T.E.C.)**

DB 508 PG 425
DB 485 PG 261
5.380 Ac.
Satellite Dish
1-Story P
Technoc
#10

SEE Pg.2 FOR
SKETCH OF
REPLACEMENT
PARKING IN
THIS AREA

Inv. In Elev. 450.26
Dnc. Pipe

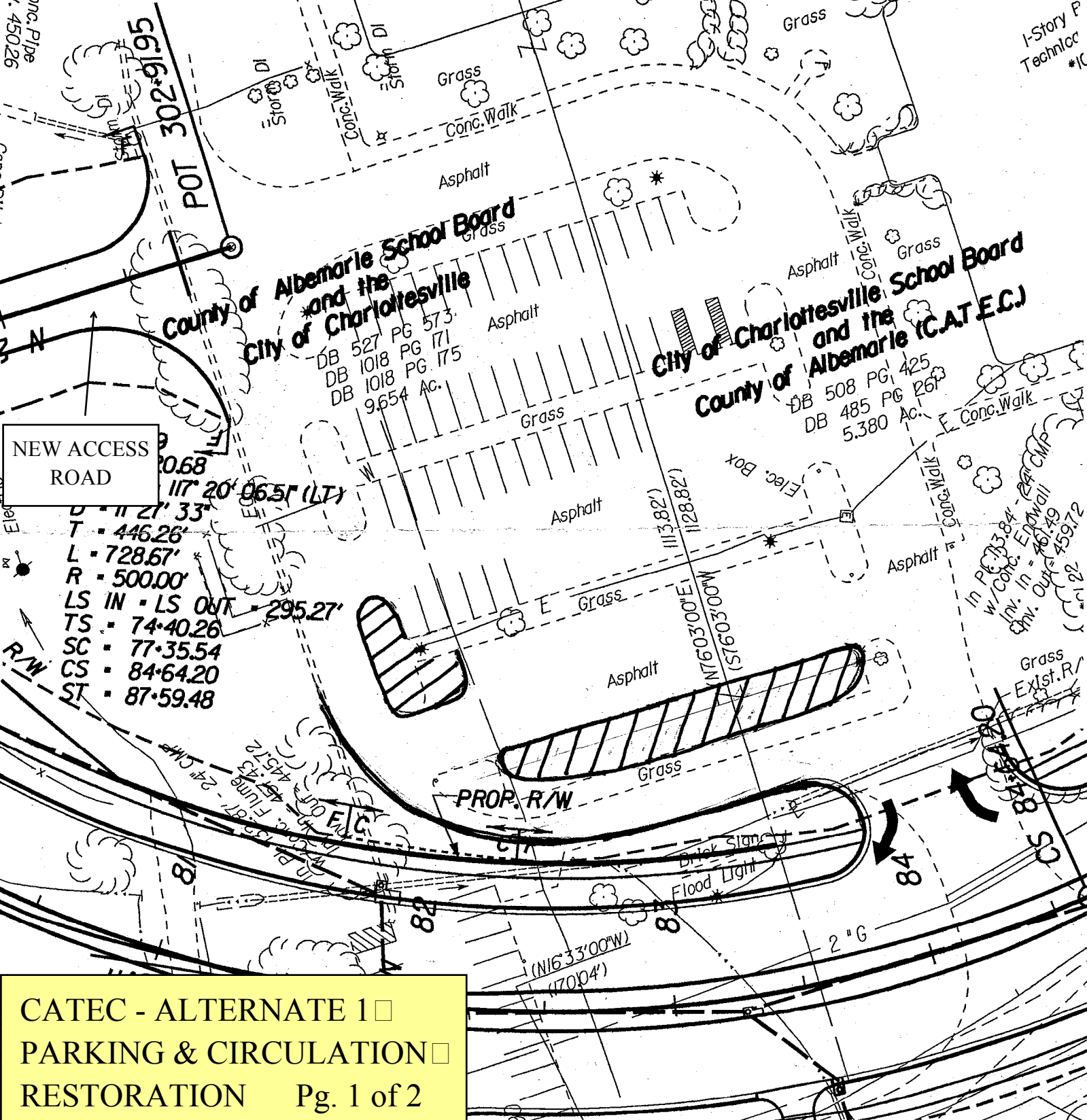

**NEW ACCESS
ROAD**

0.68
117' 20" 06.5' (LT)
D = 1127' 33"
T = 446.26'
L = 728.67'
R = 500.00'
LS IN - LS OUT = 295.27'
TS = 74.40.26
SC = 77.35.54
CS = 84.64.20
ST = 87.59.48

DB 527 PG 573
DB 1018 PG 171
DB 1018 PG 175
9.654 Ac.

DB 508 PG 425
DB 485 PG 261
5.380 Ac.

**CATEC - ALTERNATE 1
PARKING & CIRCULATION
RESTORATION Pg. 1 of 2**

